

COPY RIGHT & CONFIDENTIAL

THIS DOCUMENT IS THE EXCLUSIVE PROPERTY OF BEML & CONTAINS CONFIDENTIAL INFORMATION. THIS DOCUMENT OR ITS CONTENTS SHALL NOT BE USED, REPRODUCED OR DISCLOSED IN WHOLE OR IN PART, WITHOUT PRIOR WRITTEN PERMISSION OF BEML. THIS DOCUMENT & ALL ITS COPIES SHALL BE RETURNED TO BEML ON DEMAND.

DRAWING RELEASED FROM PLM, PHYSICAL SIGNATURE NOT REQUIRED

GRADE No.	VALUE	SYMBOL
N1	0.025	▽
N2	0.05	▽
N3	0.1	▽
N4	0.2	▽
N5	0.4	▽
N6	0.8	▽
N7	1.6	▽
N8	3.2	▽
N9	6.3	▽
N10	12.5	▽
N11	25	▽
N12	50	▽
ROUGHNESS		▽

MACHINING DEVIATIONS FOR LINEAR DIMENSIONS	RANGE	0 - 6	6 - 30	30 - 120	120 - 315	315-1000	1000-2000	2000-4000	ABOVE 4000	RA
TOLERANCE	±0.1	±0.2	±0.3	±0.5	±0.8	±1.2	±1.2	±2	±3	~
FOR DIMENSIONAL TOLERANCES OF SHEET METAL PARTS AND WELDED STRUCTURES, REFER STD: RD-227										
UNSPECIFIED TOLERANCE FOR LINEAR AND ANGULAR DIMENSIONS REF. IS 2102 (PT-1) (MEDIUM)										
VALUES OF SURFACE TEXTURE SHALL BE AS PER COMPANY STD DS. 1012.C.										
WELDING SHALL BE CARRIED OUT AS PER IS: 9595-96										
STATUS:										
QUALITY OF WELD JOINTS REF. RD 230 MEDIUM										

## MCB - 6 AMPS

### TECHNICAL REQUIREMENTS:

- NOMINAL VOLTAGE : 230V AC
- NO. OF POLES : 2
- CURRENT RATING : 6 AMPS
- TYPE OF CURVE : C CURVE
- BREAKING CAPACITY : 10 KA , ACCORDING TO IEC 60898
- CONNECTION : TUNNEL TYPE TERMINALS
- OPERATING TEMPERATURE : -25° C TO 70°C
- MAKE :
  - M/S SCHNEIDER : TYPE : A9N2P06C
  - M/S ABB : TYPE : S202-C6, ORDER NO : 2CDS 252 001 R0064

UN CONTROLLED

### NOTE:

DIMENSIONS GIVEN ARE APPROXIMATE AND ALL OTHER THINGS ARE AS PER THE MANUFACTURER'S STANDARD

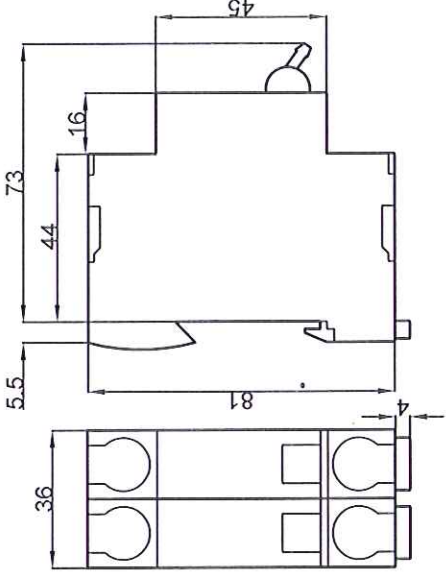

SL.No.	QTY	PART / STOCK No.	DESCRIPTION	SIZE	COMPANY STD./IS	Wt. (kg)
			PRODUCT	8W DH I&M CAR - MRVC		
			REF DRG			
			MATERIAL			
			HEAT TREAT.			
			SURFACE TREAT.			
			TITLE			
			APPD			
			REVD			
			CHKD			
			DRWN			
			SCALE			
			SHEET OF			
			Wt.(Kg)			
			0			
			DRG No.			
			899-21218			
			ALT			

BEML LIMITED



NEW INITIATIVES. NEW IDEAS.

899-21218

ALT